

'DBB' Series Double Block & Bleed

Double Block & Bleed Ball Valves with Needle Valve

6,000 psi [Pn 414] & 10,000 psi [Pn 690] Rated

DESIGN FEATURES

ISOLATING BALL VALVE :-

- * Wide choice of Flange sizes and Pressure ratings.
- * Robust HIGH pressure DESIGNED to be maintained
- * Ball Valve has anti blowout stem for safety
- * Floating ball design for positive shut-off
- * Replaceable seats & seals for extended life

NEEDLE VENT VALVE :-

- * Top Sealing Bonnet style
- * NON-Rotating hard tip on bleed valve for effective shut-off
- * Back sealing on the stem & adjustable gland packing
- * Stem Seal below actuating threads to prevent contamination & gauling of threads
- * Metal/Metal bonnet seal for pressure tightness even at elevated temperatures
- * Choice of thread forms
- * 1/4" Bleed Port with pressure plug as standard
- * 316 ss to NACE Specification, Full material traceability

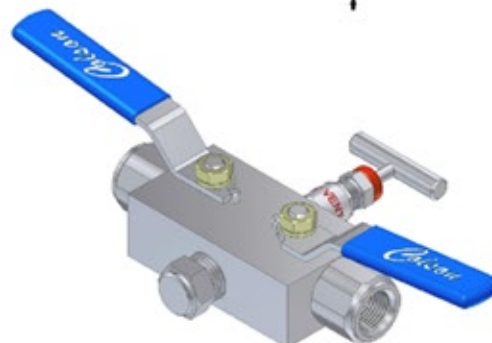
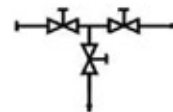

Ab=Block & Bleed Length
Ac=Double Block & Bleed Length
B =Bore
F =Ball valve centres

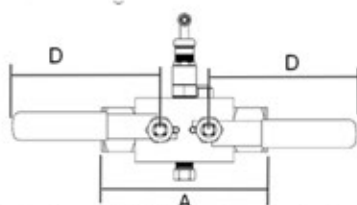

All valves have 1/4"NPT Vent port as standard



NS HEAD ASSY

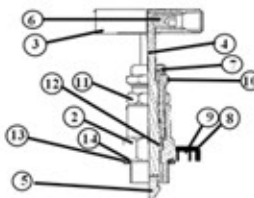

ITEM	COMPONENT	MATERIAL
1	BODY	316 S 11
2	BONNET HOUSING	316 S 11
3	HANDLE	316 S 11
4	STEM	316 S 11
5	STEM TIP	17 4 PH
6	GRUB SCREW	STAINLESS STEEL
7	DUST CAP	PVC
8	RETAINING CAM	STAINLESS STEEL
9	RETAINING SCREW	STAINLESS STEEL
10	SLAND ADJUSTER	316 S 11
11	LOCK NUT	316 S 11
12	GLAND PACKING	PTFE / GRAPHOL
13	BONNET GASKET	316 S 11
14	BONNET SEAL	V PTFE

BALL VALVE ASSY

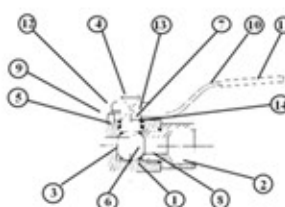

ITEM	COMPONENT	MATERIAL
1	BODY	316 S 11
2	SEAL CONNECTORS	316 S 11
3	BALL	316 S 11
4	STEM	316 S 11
5	STEM SEAL	RTFE
6	SEA	PVDF / PERK
7	TOP SEAL	RTFE
8	BODY SEAL	PTFE
9	PIN	ST STEEL
10	LEVER HANDLE	ST STEEL
11	POINTER HANDLE	MAZAK 3
12	HANDLE SLEEVE	PVC
13	NUT	A4 SS
14	WASHER	A4 SS
15	SPACER	316 SS

DIMENSION TABLE											
SIZE	Ab	Ac	B	C	C1	D	Dv	E	Ev	F	Wt
08 - 1/4"	100	126	10	51	38	115	50	29	67	31	2.2
10 - 3/8"	100	126	10	51	38	115	50	29	67	31	2.2
15 - 1/2"	100	126	10	51	38	115	50	29	67	31	2.2
20 - 3/4"	100	126	12.7	51	38	115	50	31	67	37	2.25
25 - 1"	143	180	19	51	51	165	50	35	67	40	4.0

Note 6,000psi/414Bar Valves - 'A' Dim is 10mm Shorter

Sample Part Number DBBCMP1015NM15NFS

1/2"NPT (Male x Female) 6000PSI/414Bar Double Block & Bleed Ball Valve [Ball/Needle/Ball Configuration] with PVDF +PTFE/17-4PH Trim. 1/2" NPTF Outlet/1/4"NPT Vent in316ss

VALVE PART NUMBER and ORDERING TABLE									
Series - Style	Pressure	BORE	Inlet Size/Type		Outlet Size/Type		Vent	* Material	Options
DBBB	E=B/N F=B/B	P=6000/414 X=10000/690	10	08	NF=NPT(F)	08	1=1/4"NPT	D - 31803 Duplex S - 316 SS	-PH Pointer Handle -TH 'T' Handle St St -LK Lock Kit
			13	10	NM=NPT(M)	10	2=1/4BS		
			15	15		15	PP		
DBBC	K=B/N/N M=B/N/B	Psi/Bar	20	20	PF=BSPP(F)	20			
			19	25		25			

We reserve the right to change specifications stated in this leaflet due to our continuing programme of development.
All Ball valves have lever handle as standard.

DBB - 09/09



Colson X-Cel Ltd, Park Works, Park Road, Elland, West Yorkshire HX5 9HN United Kingdom
Tel: +44 (0) 1422 377 999 Fax: +44 (0) 1422 377 333
Web: www.colson.co.uk Email: sales@colson.co.uk

