

'DBN' Series Double Block & Bleed**Double Block & Bleed Needle Valves****6,000 psi [Pn 414] & 10,000 psi [Pn 690] Rated****DESIGN FEATURES**

- Top Sealing Bonnet style
- Wide choice of Thread sizes and Pressure ratings.
- Robust HIGH pressure design
- DESIGNED to be maintained
- 2 piece stem with NON-Rotating tip as standard
- Hard TIP for effective shut-off and life
- Low operating torque - back sealing on the stem
- Smooth 6 turns from OPEN to CLOSE
- 316 ss to NACE Specification
- Choice of Block & Bleed or Double Block & Bleed
- Adjustable gland packing [SNV] or LoTork [LNV]
- Vent Port with pressure plug as standard
- Full material traceability
- Stem Seal below actuating threads to prevent contamination & gauling of threads
- Metal/Metal bonnet seal for pressure tightness even at elevated temperatures

All valves have 1/4"NPT Vent port as standard

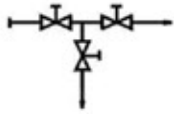
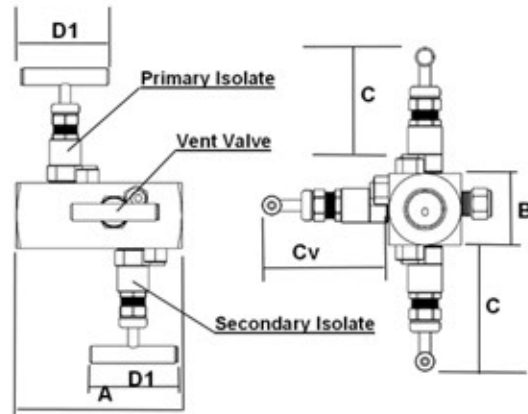
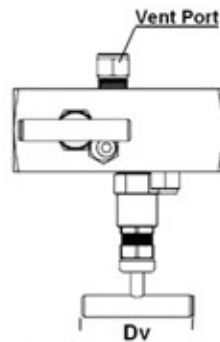
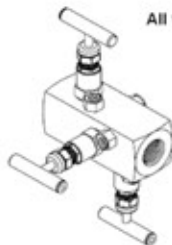

Materials - 316ss Valve

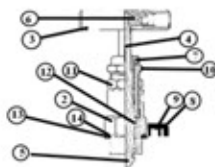
NS HEAD ASSY

ITEM	COMPONENT	MATERIAL
1	BODY	316 S 11
2	BONNET HOUSING	316 S 11
3	HANDLE	316 S 11
4	STEM	316 S 11
5	STEM TIP	17/4 PH
6	GRUB SCREW	STAINLESS STEEL
7	DUST CAP	PVC
8	RETAINING CAM	STAINLESS STEEL
9	RETAINING SCREW	STAINLESS STEEL
10	GLAND ADJUSTER	316 S 11
11	LOCK NUT	316 S 11
12	GLAND PACKING	PTFE / GRAPHOL
13	BONNET GASKET	316 S 11
14	BONNET SEAL	V PIPE

DIMENSION TABLE

SIZE	A	B	C	Cv	D1	Dv	Wt
08 - 1/4"	95	38	67	67	50	50	1.30
10 - 3/8"	95	38	67	67	50	50	1.30
15 - 1/2"	95	38	67	67	50	50	1.30
20 - 3/4"	150	45	90	67	60	50	2.10
25 - 1"	150	45	90	67	60	50	2.10

Sample Part Number DBNCNP0825NF25NF1S

1"NPT 6000PSI/414 Bar Double Block & Bleed Needle Valve [Needle/ Needle/Needle Configuration] with PTFE/17-4PH Trim.
 1" NPTF Outlet/1/4"NPT Vent in 316ss

VALVE PART NUMBER and ORDERING TABLE

Series - Style	Pressure	BORE	Inlet Size/Type	Outlet Size/Type	Vent	Material	Options
DBNB	P=6000/414	05	08	08	1=1/4"NPT 3=1/2"NPT	A - Ali-Bronze D - 31803 Duplex S - 316 SS	-AT AntiTamper -HW Handwheel 316 SS
			10	10			
			15	15			
DBNC	X=10000/690	08	20	20			
	Psi/Bar		25	25			
N=N/N/N							

We reserve the right to change specifications stated in this leaflet due to our continuing programme of development.
 All Needle valves have Tee handle as standard.

DBN - 01/08