

# DFB Series, Double Flange DBB Ball, Needle, Ball Style

## DESIGN FEATURES

### Ball Valve

#### ISOLATE VALVE :-

- \* One Piece Body from 1 piece Forging
- \* Wide choice of Flange sizes and Pressure ratings.
- \* Robust HIGH pressure DESIGNED to be maintained
- \* Ball Valve has anti blowout stem for safety
- \* Floating ball design for positive shut-off
- Trunnion mounted ball alternative - See 'DM T'
- \* Replaceable seats & seals for extended life

### Needle Vent Valve

- \* Top Sealing Bonnet style
- \* NON-Rotating hard tip on bleed valve for effective shut-off
- \* Back sealing on the stem & adjustable gland packing
- \* Stem Seal below actuating threads to prevent contamination & galling of threads
- \* Metal/Metal bonnet seal for pressure tightness even at elevated temperatures
- \* Bleed Port with socket pressure plug or Tube fitting
- \* 316 ss to NACE Specification, Full material traceability



### NS HEAD ASSY

ITEM	COMPONENT	MATERIAL
1	BODY	316 S 11 *
2	BONNET HOUSING	316 S 11 *
3	HANDLE	316 S 11
4	STEM	316 S 11
5	STEM TIP	17 / 4 PH
6	GRUB SCREW	STAINLESS STEEL
7	DUST CAP	PVC
8	RETAINING CAM	STAINLESS STEEL
9	RETAINING SCREW	STAINLESS STEEL
10	GLAND ADJUSTER	316 S 11
11	LOCK NUT	316 S 11
12	GLAND PACKING	PTFE / GRAPHOIL
13	BONNET GASKET	316 S 11
14	BONNET SEAL	V PTFE

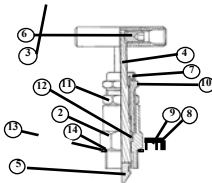

### DMB BALL VALVE ASSY B/N/B

ITEM	COMPONENT	MATERIAL
1	BODY	316 S 11
2	END FLANGE	316 S 11
3	BALL	316 S 11
4	STEM	316 S 11
5	STEM SEAL	PTFE/GRAPHOIL
6	SEATS	PTFE /
7	TOP SEAL	RTFE/GRAPHO
8	END FLANGE SEAL	
9	PIN	STAINLESS STEEL
10	LEVER HANDLE	STAINLESS STEEL
11	HANDLE SLEEVE	PVC
12	NUT	A4 ss
13	WASHER	A4 ss
14	F.E. Seal	Viton
15	CAVITY PLUG	316 S 11

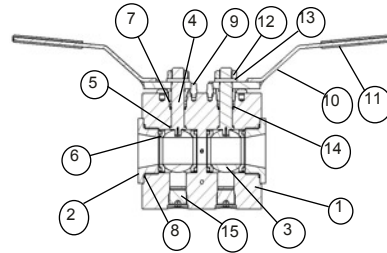

Sample Part No.  
DF BCMF1925CB3S

1"600lb Serrated Face Flanged Inlet & Outlet Double Block & Bleed Valve [B/N/B Configuration] . 1/2"NPT F Vent Valve with PTFE/17-4PH Trim in 316ss

## VALVE PART NUMBER and ORDERING TABLE

Series - Style		PRESSURE F = Flange Rating	BORE / Orifice		Inlet Size/Type/Finish	Vent	Material	Options	
DF FC	B=Ball E=B/N		Ball Valves	Needle Valves					
DF FF	F=B/B	10 15 20 25 32 40 46 50 54 65	10 15 20 25 32 40 46 50 54 65	05 08	A=C150 B=C300 C=C600 D=C800 E=C900 F=C1500 G=C2500 For API 5K use 46 or 54	A= Smooth  B= Serrated  C=RTJ  H=HUB	1=1/4"NPT 2=1/4BSPP 3=1/2"NPT 4=1/2BSPP 5=3/4"NPT 6=3/4BSPP 7=1"NPT 8=1BSPP	D = F51 Duplex  L = LF2  S = F 316	-LK Locking Kit -AT AntiTamper Head Unit -ATK A/T Key -HW Handwheel 316 SS -Tg Tagging
	G=B/B/B K=B/N/N M=B/N/B								

We reserve the right to change specifications stated in this leaflet due to our continuing programme of development. All Ball valves have lever handle as standard. Ball & stem materials will be the same as the body material except for LF2 which has 316 trim. All Needle valves have 'T' Bar handle as standard. Anti-Tamper Keys are always supplied separately, for security.