

# DFC Series Double Block & Bleed

## Modular Block & Bleed Chemical Injection Valves

### DESIGN FEATURES

#### ISOLATE VALVE :-

- \* Top Sealing Bonnet style
- \* Wide choice of Flange and/or thread sizes and Pressure Class or psi/Bar ratings. [MODULAR DESIGN]
- \* Robust HIGH pressure DESIGNED to be maintained
- \* OS&Y Primary Isolate Valve optional
- \* **Large Head assembly for Primary Isolate**
- \* NON-Rotating hard tip for effective shut-off
- \* Back sealing on the stem & adjustable gland packing
- \* Stem Seal below actuating threads to prevent contamination and gauling of threads
- \* Metal/Metal bonnet seal for pressure tightness even at elevated temperatures.
- \* Choice of Block, Block & Bleed or Double Block& Bleed
- \* 316 ss to NACE Specification, Full material traceability

#### VENT VALVE :- as above but including

- \* Anti-Tamper Head unit as option
- \* Vent/outlet Port can be supplied with o.d. tube fitting

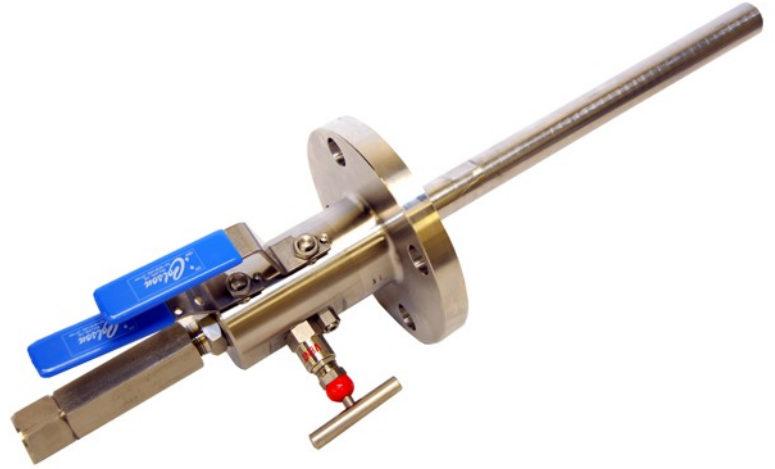

### SNV HEAD ASSY

ITEM	COMPONENT	MATERIAL
1	BODY	316 S 11
2	BONNET HOUSING	316 S 11
3	HANDLE	316 S 11
4	STEM	316 S 11
5	STEM TIP	17 / 4 PH
6	GRUB SCREW	STAINLESS STEEL
7	DUST CAP	PVC
8	RETAINING CAM	STAINLESS STEEL
9	RETAINING SCREW	STAINLESS STEEL
10	GLAND ADJUSTER	316 S 11
11	LOCK NUT	316 S 11
12	GLAND PACKING	RTFE / GRAPHOIL
13	BONNET GASKET	316 S 11
14	BONNET SEAL	V PTFE

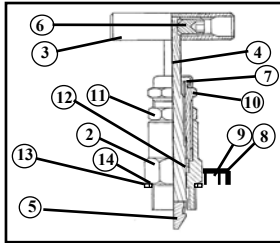

### BALL VALVE ASSY

ITEM	COMPONENT	MATERIAL
1	Vent BODY	A182 F316L
2	FLANGE BODY	316 S 11
3	BALL	316 S 11
4	STEM	316 S 11
5	STEM SEAL	PTFE/GRAPHOIL
6	SEATS	PTFE / PVDF/PEEK
7	TOP SEAL	RTFE/GRAPHO
8	END FLANGE SEAL	PTFE/GRAPHOIL
9	PIN	STAINLESS STEEL
10	LEVER HANDLE	STAINLESS STEEL
11	HANDLE SLEEVE	PVC
12	NUT	A4 ss
13	WASHER	A4 ss
14	SPACER	316 SS
15	PROBE	316 SS
16	VENT PLUG	316 SS

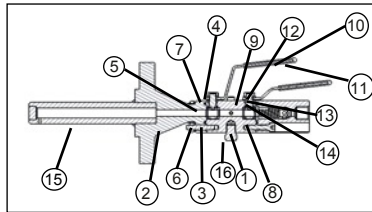

1"600lb Serrated Face Flange Double Block & Bleed Injection Valve with Probe and Check valve in 316ss Ball Valve Primary & Secondary Isolate, Needle vent valve with PTFE/17-4PH Trim. 1/2"NPT Outlet/1/4"NPT Vent

Part No DFCCMF1015CA15NF3S-78

VALVE PART NUMBER and ORDERING TABLE													
Series - Style	PRESSURE	BORE	Inlet Size/Type/Finish		Outlet Size/Type/Finish		Vent	* Material	Options	Probe Length			
<b>DFCC</b>	M=B/N/B  N-N/N/N	F=Flange Rating A=1,000/69 S=3000/207 P=6000/414 X=10000/690	10	08	A=C150	A= Smooth	08	A=C150	A= Smooth	1=1/4"NPT 2=1/4BSPP 3=1/2"NPT 4=1/2BSPP 5=3/4"NPT 6=3/4BSPP 7=1"NPT 8=1BSPP	A - All-Bronze C - C/Steel D - Duplex SS H - Hasteloy I - Incoloy M - Monel S - 316 SS X - SPECIAL	-Tg Tagging -H Handwheel -LK Locking Kit -AT AntiTamper Head Unit -ATK A/T Key -HW Handwheel 316 SS -Tg Tagging	Specify in mm
				10	C=C600	B= Serrated	10	B=C300	B= Serrated				
				15	D=C800	C=RTJ	15	D=C800	C=RTJ				
				20	E=C900	H=HUB	20	E=C900	H=HUB				
			25	F=C1500		25	F=C1500						
			32	G=C2500		32	G=C2500						
			40			40							
			46	NF=NPT(F) NM=NPT(M)		46	NF=NPT(F) NM=NPT(M)						
			50			50							
			54	PF=BSPP(F) PM=BSPP(M)		54	PF=BSPP(F) PM=BSPP(M)						

We reserve the right to change specifications stated in this leaflet due to our continuing programme of development. All Needle valves have 'T' Bar handle as standard. Anti-Tamper Keys are always supplied separately, for security. It is always advised that the valve is supported and not left to carry the weight of the pipework as damage may occur. \* = API Flange 1-13/16" & 2-1/16".