

DFF Series Style Block & Bleed VALVES

Flanged Block & Bleed Ball Valves with Needle Valve Vent

DESIGN FEATURES

ISOLATE VALVE :-

- * Wide choice of Flange sizes and Pressure ratings.
- * Robust HIGH pressure DESIGNED to be maintained
- * Ball Valve has anti blowout stem for safety
- * Floating ball design for positive shut-off
- * Replaceable seats & seals for extended life

VENT VALVE :-

- * Top Sealing Bonnet style
- * NON-Rotating hard tip on bleed valve for effective shut-off
- * Back sealing on the stem & adjustable gland packing
- * Stem Seal below actuating threads to prevent contamination & gauling of threads
- * Metal/Metal bonnet seal for pressure tightness even at elevated temperatures

- * Choice of Block, Block & Bleed or Double Block & Bleed
- * Bleed Port with socket pressure plug or Tube fitting
- * 316 ss to NACE Specification, Full material traceability
- * Barstock Material '**FB**' and Forged Body '**FF**'

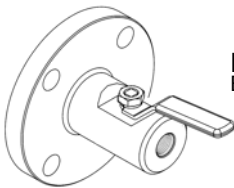

DF FA Series
Block [Isolate] Only

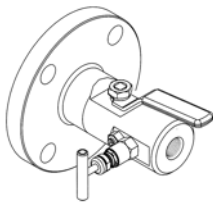

DF FB Series
Block & Bleed

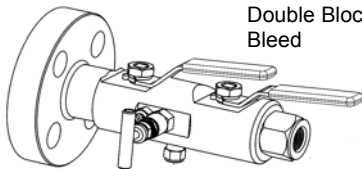

DF FC Series
Double Block & Bleed

DF B BALL VALVE ASSY B/N/B

ITEM	COMPONENT	MATERIAL
1	BODY	316 S 11
2	END FLANGE	316 S 11
3	BALL	316 S 11
4	STEM	316 S 11
5	STEM SEAL	PTFE/GRAPHOIL
6	SEATS	PTFE / PVDF/PEEK
7	TOP SEAL	RTFE/GRAPHO
8	END FLANGE SEAL	PTFE/GRAPHOIL
9	PIN	STAINLESS STEEL
10	LEVER HANDLE	STAINLESS STEEL
11	HANDLE SLEEVE	PVC
12	NUT	A4 ss
13	WASHER	A4 ss
14	F.E. Seal	Viton
15	CAVITY PLUG	316 S 11

NS HEAD ASSY

ITEM	COMPONENT	MATERIAL
1	BODY	316 S 11 *
2	BONNET HOUSING	316 S 11 *
3	HANDLE	316 S 11
4	STEM	316 S 11
5	STEM TIP	17 / 4 PH
6	GRUB SCREW	STAINLESS STEEL
7	DUST CAP	PVC
8	RETAINING CAM	STAINLESS STEEL
9	RETAINING SCREW	STAINLESS STEEL
10	GLAND ADJUSTER	316 S 11
11	LOCK NUT	316 S 11
12	GLAND PACKING	PTFE / GRAPHOIL
13	BONNET GASKET	316 S 11
14	BONNET SEAL	V PTFE

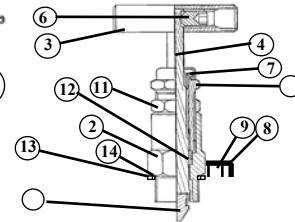
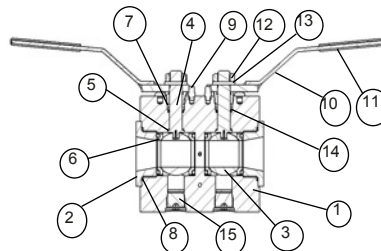

Sample Part Number DF FCMF1025CB15NF1S

1"600lb Serrated Face Flanged Double Block & Bleed Valve [Ball/Needle/Ball Configuration] with PTFE/17-4PH Trim.
1/2"NPT [F] Outlet/1/4"NPT Vent in 316ss

Do not repeat the OUTLET PART NUMBER if same as INLET

VALVE PART NUMBER and ORDERING TABLE

Series - Style	PRESSURE	BORE	Inlet Size/Type/Finish		Outlet Size/Type/Finish		Vent	* Material	Options
Forged DF FA DF FB DF FC	F=Flange Rating A=1,000/69 S=3000/207 P=6000/414 X=10000/690	10 13	08	A=C150	A= Smooth	08	A=C150	1=1/4"NPT 2=1/4BS PP 3=1/2"NPT 4=1/2BS PP 5=3/4"NPT 6=3/4BS	A - Ali-Bronze C - C/Steel D - Duplex SS H - Hasteloy I - Incoloy M - Monel S - 316 SS X - SPECIAL
			10	B=C300	B= Smooth	10	B=C300		
			15	C=C600	B= Serrated	15	C=C600		
			20	D=C800	C=RTJ	20	D=C800		
			25	E=C900		25	E=C900		
			32	F=C1500		32	F=C1500		
			40	G=C2500	H=HUB	40	G=C2500		
			46	NF=NPT(F)		46	NF=NPT(F)		
			50	NM=NPT(M)		50	NM=NPT(M)		
			54	PF=BSPP(F)		54	PF=BSPP(F)		
65	PM=BSPP(M)		65	PM=BSPP(M)					

We reserve the right to change specifications stated in this leaflet due to our continuing programme of development.

All Ball valves have lever handle as standard. Anti-Tamper Keys are always supplied separately, for security.

Ball & stem materials will be the same as the body material except for C/Steel which has 316 trim.