

# DFN Series Block & Bleed VALVES

## Flanged Block & Bleed Needle Valves

### DESIGN FEATURES

#### ISOLATE VALVE :-

- \* Top Sealing Bonnet style
- \* Wide choice of Flange sizes and Pressure ratings.
- \* Robust HIGH pressure DESIGNED to be maintained
- \* OS&Y Primary Isolate Valve optional
- \* **Large Head assembly for Primary/Secondary Isolate**
- \* NON-Rotating hard tip for effective shut-off
- \* Back sealing on the stem & adjustable gland packing
- \* Stem Seal below actuating threads to prevent contamination and gauling of threads
- \* Metal/Metal bonnet seal for pressure tightness even at elevated temperatures.
- \* Choice of Block, Block & Bleed or Double Block & Bleed
- \* 316 ss to NACE Specification, Full material traceability

#### VENT VALVE :- as above but including

- \* Anti-Tamper Head unit as option
- \* Bleed Port with socket pressure plug or Tube fitting

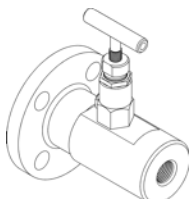

**DFNA Series  
Block [Isolate]**

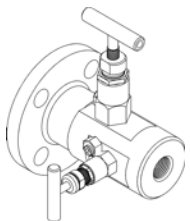

**DFNB Series  
Block & Bleed**

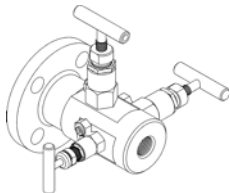

**DFNC Series  
Double Block & Bleed**

Part No. DFNCNF0825CB15NF1S

### OS&Y HEAD ASSY

ITEM	COMPONENT	MATERIAL
1	FLANGE BODY	316 S 11 *
2	BONNET HOUSING	316 S 11 *
3	HANDLE	316 S 11 *
4	STEM	316 S 11 *
5	STEM TIP	17/4 PH *
6	GRUB SCREW	STAINLESS STEEL
7	YOKE NUT	STAINLESS STEEL
8	YOKE	316 S 11
9	SPRING WASHER	STAINLESS STEEL
10	CAP SCREW	STAINLESS STEEL
11	GLAND	316 S 11
12	GLAND PACKING	PTFE / GRAPHOIL
13	YOKE ADJUST BOLT	STAINLESS STEEL

### NS HEAD ASSY

ITEM	COMPONENT	MATERIAL
1	BODY	316 S 11 *
2	BONNET HOUSING	316 S 11 *
3	HANDLE	316 S 11
4	STEM	316 S 11
5	STEM TIP	17/4 PH
6	GRUB SCREW	STAINLESS STEEL
7	DUST CAP	PVC
8	RETAINING CAM	STAINLESS STEEL
9	RETAINING SCREW	STAINLESS STEEL
10	GLAND ADJUSTER	316 S 11
11	LOCK NUT	316 S 11
12	GLAND PACKING	PTFE / GRAPHOIL
13	BONNET GASKET	316 S 11
14	BONNET SEAL	V PTFE

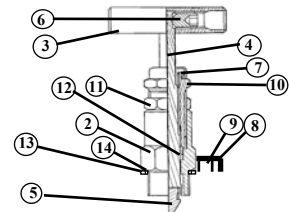
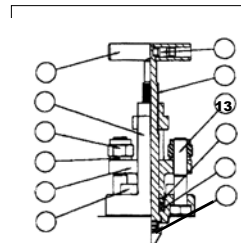

1"600lb Serrated Face Flanged Double Block & Bleed Valve [Needle/ Needle/Needle Configuration] with PTFE/17-4PH Trim. 1/2"NPT Outlet/1/4"NPT Vent in 316ss

### VALVE PART NUMBER and ORDERING TABLE

Series - Style	PRESSURE	BORE	Inlet Size/Type/Finish	Outlet Size/Type/Finish	Vent	* Material	Options
<b>DFNA</b>	A=Needle	F=Flange Rating	08 A=C150	08 A=C150	1=1/4"NPT	A - All-Bronze	-AT AntiTamper Head Unit
<b>DFNB</b>	C=N/B		10 B=C300	10 B=C300			
<b>DFNC</b>	D=N/N	A=1,000/69 S=3000/207 P=6000/414 X=10000/690	15 C=C600	15 C=C600	3=1/2"NPT	C - C/Steel	-ATK A/T Key
<b>DFND</b>	H=N/N/B		20 D=C800	20 D=C800	4=1/2BSPP		
<b>DFNE</b>	J=N/B/B	H=HUB	25 E=C900	25 E=C900	5=3/4"NPT	D - Duplex SS	-HW Handwheel 316 SS
<b>DFNF</b>	N=N/N/N		32 F=C1500	32 F=C1500	6=3/4BSPP		
			40 G=C2500	40 G=C2500	7=1"NPT	I - Incoloy	-Tg Tagging
			46 NF=NPT(F)	46 NF=NPT(F)	8=1BSPP		
			50 NM=NPT(M)	50 NM=NPT(M)		M - Monel	
			54 PF=BSPP(F)	54 PF=BSPP(F)		S - 316 SS	
			65 PM=BSPP(M)	65 PM=BSPP(M)		X - SPECIAL	

We reserve the right to change specifications stated in this leaflet due to our continuing programme of development.

All Needle valves have 'T' Bar handle as standard. Anti-Tamper Keys are always supplied separately, for security.

Do not repeat the OUTLET PART NUMBER if same as INLET



Quality, Integrity, Experience

Colson X-Cel Ltd, Park Works, Park Road, Elland,  
West Yorkshire HX5 9HN United Kingdom

Tel: +44 (0) 1422 377 999 Fax: +44 (0) 1422 377 333  
Web: www.colson.co.uk Email: sales@colson.co.uk