

# 'DM'Series 'B' Style, Block & Bleed VALVES

## Modular Block & Bleed Ball Valves, Needle Valve Vent

### DESIGN FEATURES

#### ISOLATE VALVE :-

- \* Firesafe tested Design to BS 6755 Pt 2
- \* Top Sealing Bonnet style
- \* Wide choice of Flange Rating & Threaded ends.
- \* Robust HIGH pressure DESIGNED to be maintained
- \* Ball Valve has anti blowout stem for safety
- \* Floating ball design for positive shut-off
- \* Trunnion Mounted Ball Available
- \* Replaceable seats & seals for extended life

#### VENT VALVE :-

- \* NON-Rotating hard tip on bleed valve for effective shut-off
- \* Back sealing on the stem & adjustable gland packing
- \* Stem Seal below actuating threads to prevent contamination & gauling of threads
- \* Metal/Metal bonnet seal for pressure tightness even at elevated temperatures

- \* Choice of Block, Block & Bleed or Double Block & Bleed
- \* Bleed Port with socket pressure plug or Tube fitting
- \* 316 ss to NACE Specification & Full material traceability

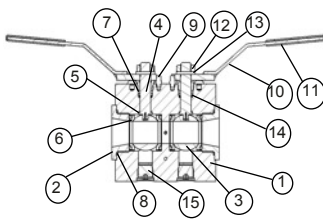

**DMB BALL VALVE  
ASSY B/N/B**

ITEM	COMPONENT	MATERIAL
1	BODY	316 S 11
2	END FLANGE	316 S 11
3	BALL	316 S 11
4	STEM	316 S 11
5	STEM SEAL	PTFE/GRAPHOIL
6	SEATS	PTFE / PVDF/PEEK
7	TOP SEAL	RTFE/GRAPHOIL
8	END FLANGE SEAL	PTFE/GRAPHOIL
9	PIN	STAINLESS STEEL
10	LEVER HANDLE	STAINLESS STEEL
11	HANDLE SLEEVE	PVC
12	NUT	A4 ss
13	WASHER	A4 ss
14	F.E. Seal	Viton
15	CAVITY PLUG	316 S 11

**SNV HEAD ASSY**

ITEM	COMPONENT	MATERIAL
1	BODY	316 S 11
2	BONNET HOUSING	316 S 11
3	HANDLE	316 S 11
4	STEM	316 S 11
5	STEM TIP	17 / 4 PH
6	GRUB SCREW	STAINLESS STEEL
7	DUST CAP	PVC
8	RETAINING CAM	STAINLESS STEEL
9	RETAINING SCREW	STAINLESS STEEL
10	GLAND ADJUSTER	316 S 11
11	LOCK NUT	316 S 11
12	GLAND PACKING	RTFE / GRAPHOIL
13	BONNET GASKET	316 S 11
14	BONNET SEAL	V PTFE

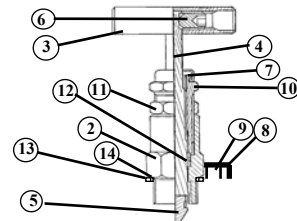

Part No. DM BCM F1925CB15NF15

1"600lb Serrated Face Flanged Double Block & Bleed Valve [Ball/Needle/Ball Configuration] with PTFE/17-4PH Trim. 1/2"NPT Outlet/1/4"NPT Vent in316ss

### VALVE PART NUMBER and ORDERING TABLE

Series - Style	PRESSURE	BORE	Inlet Size/Type/Finish	Outlet Size/Type/Finish	Vent	* Material	Options
<b>DM BA</b>	B=Ball E=B/N	F=Flange Rating	06	A=C150 A=Smooth	08	A=C150 A=Smooth	1=1/4"NPT A - All-Bronze -Tg Tagging
			10	B=C300 B=Smooth	10	B=C300 B=Smooth	2=1/4BSPP C - C/Steel -H Handwheel
			15	C=C600 C=Serrated	15	C=C600 C=Serrated	3=1/2"NPT D - Duplex SS -LK Locking Kit
<b>DM BB</b>	F=B/B	A=1,000/69 S=3000/207 P=6000/414 X=10000/690	13	D=C800 D=Serrated	20	D=C800 D=Serrated	4=1/2BSPP H - Hasteloy -AT AntiTammer Head Unit
			20	E=C900 E=C900	25	E=C900 E=C900	5=3/4"NPT 6=3/4BSPP 7=1"NPT 8=1BSPP
			25	F=C1500 G=C2500	32	F=C1500 G=C2500	
<b>DM BC</b>	K=B/N/N M=B/N/B		32	NF=NPT(F) NM=NPT(M)	46	NF=NPT(F) NM=NPT(M)	M - Monel -ATK A/T Key
			38		50		S - 316 SS -HW Handwheel 316 SS
			50	PF=BSPP(F) PM=BSP	54	PF=BSPP(F) PM=BSPP(M)	X - SPECIAL -Tg Tagging

We reserve the right to change specifications stated in this leaflet due to our continuing programme of development. All Ball valves have lever handle as standard. Anti-Tamper Keys are always supplied separately, for security. Ball & stem materials will be the same as the body material except for C/Steel which has 316 trim. It is always recommended that the valve is supported and not left to carry the weight of the pipework as damage may occur.