

DMB Series Block & Bleed VALVES

Modular Block & Bleed Ball Valves, Needle Valve Vent

DESIGN FEATURES

ISOLATE VALVE :-

- * Firesafe tested Design to BS 6755 Pt 2
- * Top Sealing Bonnet style
- * Wide choice of Flange Rating & Threaded ends
- * Robust HIGH pressure DESIGNED
- * Ball Valve has anti blowout stem for safety
- * Floating ball design for positive shut-off
- * Trunnion Mounted Ball Available
- * Replaceable seats & seals for extended life

VENT VALVE :-

- * NON-Rotating hard tip on bleed valve for effective shut-off
- * Back sealing on the stem & adjustable gland packing
- * Stem Seal below actuating threads to prevent contamination & gauling of threads
- * Metal/Metal bonnet seal for pressure tightness even at elevated temperatures

- * Choice of Block, Block & Bleed or Double Block & Bleed
- * Bleed Port with socket pressure plug or Tube fitting
- * 316 ss to NACE Specification & Full material traceability

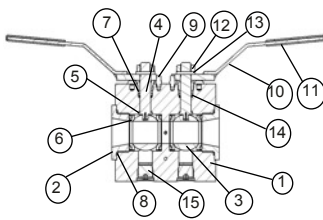

**DMB BALL VALVE
ASSY B/N/B**

ITEM	COMPONENT	MATERIAL
1	BODY	316 S 11
2	END FLANGE	316 S 11
3	BALL	316 S 11
4	STEM	316 S 11
5	STEM SEAL	PTFE/GRAPHOIL
6	SEATS	PTFE / PVDF/PEEK
7	TOP SEAL	RTFE/GRAPHOIL
8	END FLANGE SEAL	PTFE/GRAPHOIL
9	PIN	STAINLESS STEEL
10	LEVER HANDLE	STAINLESS STEEL
11	HANDLE SLEEVE	PVC
12	NUT	A4 ss
13	WASHER	A4 ss
14	F.E. Seal	Viton
15	CAVITY PLUG	316 S 11

SNV HEAD ASSY

ITEM	COMPONENT	MATERIAL
1	BODY	316 S 11
2	BONNET HOUSING	316 S 11
3	HANDLE	316 S 11
4	STEM	316 S 11
5	STEM TIP	17 / 4 PH
6	GRUB SCREW	STAINLESS STEEL
7	DUST CAP	PVC
8	RETAINING CAM	STAINLESS STEEL
9	RETAINING SCREW	STAINLESS STEEL
10	GLAND ADJUSTER	316 S 11
11	LOCK NUT	316 S 11
12	GLAND PACKING	RTFE / GRAPHOIL
13	BONNET GASKET	316 S 11
14	BONNET SEAL	V PTFE

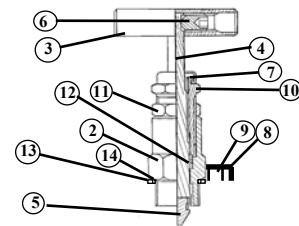

Part No. DM BCM F1925CB15NF1S

1"600lb Serrated Face Flanged Double Block & Bleed Valve [Ball/Needle/Ball Configuration] with PTFE/17-4PH Trim. 1/2"NPT Outlet/1/4"NPT Vent in316ss

VALVE PART NUMBER and ORDERING TABLE

Series - Style	PRESSURE	BORE	Inlet Size/Type/Finish		Outlet Size/Type/Finish		Vent	* Material	Options		
DM BA	B=Ball E=B/N	F=Flange Rating	06	A=C150	A= Smooth	08	A=C150	A= Smooth	1=1/4"NPT	A - All-Bronze	-Tg Tagging
			10	B=C300	B= Smooth	10	B=C300	B= Smooth	2=1/4BSPP	C - C/Steel	-H Handwheel
			15	C=C600	B= Serrated	15	C=C600	B= Serrated	3=1/2"NPT	D - Duplex SS	-LK Locking Kit
DM BB	F=B/B	A=1,000/69 S=3000/207 P=6000/414 X=10000/690	20	D=C800	C=RTJ	20	D=C800	C=RTJ	4=1/2BSPP	H - Hasteloy	-AT AntiTamper Head Unit
			25	E=C900	H=HUB	25	E=C900	H=HUB	5=3/4"NPT	I - Incoloy	
			32	F=C1500		32	F=C1500		6=3/4BSPP	M - Monel	
DM BC	G=B/B/B K=B/N/N M=B/N/B		40	G=C2500		40	G=C2500		7=1"NPT	S - 316 SS	-ATK A/T Key
			46	NF=NPT(F)		46	NF=NPT(F)		8=1BSPP	X - SPECIAL	-HW Handwheel 316 SS
			50	NM=NPT(M)		50	NM=NPT(M)				
			54	PF=BSPP(F) PM=BSP		54	PF=BSPP(F) PM=BSPP(M)				-Tg Tagging

We reserve the right to change specifications stated in this leaflet due to our continuing programme of development. All Ball valves have lever handle as standard. Anti-Tamper Keys are always supplied separately, for security. Ball & stem materials will be the same as the body material except for C/Steel which has 316 trim. It is always recommended that the valve is supported and not left to carry the weight of the pipework as damage may occur.