

'DMF' Series MONO Flange VALVES

Mono Flange Valves with NS Head units

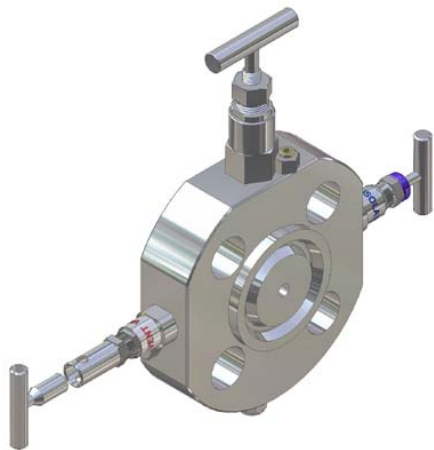

DESIGN FEATURES

- * Top Sealing Bonnet style
- * Wide choice of Flange sizes and Pressure ratings.
- * Robust HIGH pressure design
- * DESIGNED to be maintained
- * 2 piece stem with NON-Rotating tip as standard
- * Hard TIP for effective shut-off and life
- * Low operating torque, Back sealing on the stem
- * Smooth 6-7 turns from OPEN to CLOSE
- * Vent valve fitted Anti-tamper head as standard
- * 316 ss to NACE Specification
- * Choice of Block, Block & Bleed or Double Block & Bleed
- * Adjustable gland packing
- * Vent Port with socket pressure plug or Tube fitting
- * Full material traceability
- * Stem Seal below actuating threads to prevent
 - contamination & gauling of threads
- * Metal/Metal bonnet seal for pressure tightness
 - even at elevated temperatures

DMFA Series - Block Only

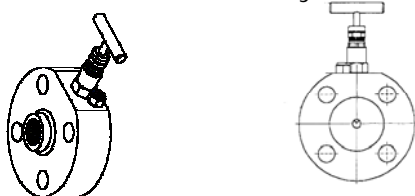

DMFB Series - Block & Bleed



DMFC Series - Double Block & Bleed

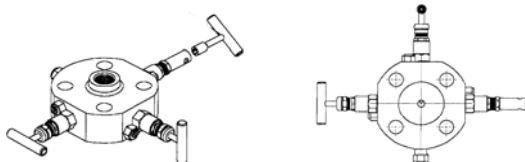

ITEM	COMPONENT	MATERIAL
1	BODY	316 S 11 *
2	BONNET HOUSING	316 S 11 *
3	HANDLE	316 S 11
4	STEM	316 S 11
5	STEM TIP	17 / 4 PH
6	GRUB SCREW	STAINLESS STEEL
7	DUST CAP	PVC
8	RETAINING CAM	STAINLESS STEEL
9	RETAINING SCREW	STAINLESS STEEL
10	GLAND ADJUSTER	316 S 11
11	LOCK NUT	316 S 11
12	GLAND PACKING	PTFE / GRAPHOIL
13	BONNET GASKET	316 S 11
14	BONNET SEAL	V PTFE

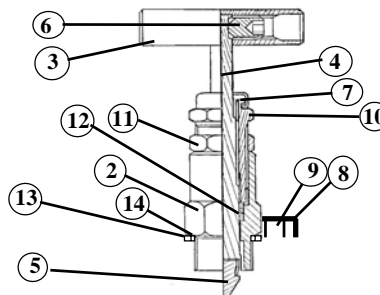

Part No. DMFCNF0825CB15NF1S

1"600lb Serrated Face Flanged Double Block & Bleed Valve [Needle/ Needle Configuration] with PTFE/17-4PH Trim. 1/2"NPT [F]Outlet/1/4"NPT [F] Vent in 316ss

VALVE PART NUMBER and ORDERING TABLE								
Series - Style	PRESSURE	BORE	Inlet Size/Type/Finish		Outlet Size/Type	Vent	* Material	Options
DMFAA = Needle	F=Flange Rating	05	08 10 15 20	A=C150 B=C300 C=C600	A= Smooth	08	NF=NPT(F) NM=NPT(M)	AT Anti Tamper Head unit
DMFBD = N/N	THREADED A=1,000/69 S=3000/207 P=6000/414 X=10000/690	08	20 25 32 40 46 50 54	D=C800 E=C900 F=C1500 G=C2500	B= Serrated C=RTJ	10 15 20 25	PF=BSPP(F) PM=BSPP(M) TF=BSPT(F) TM+BSPT(M)	ATK A/T Key HW Handwheel 316ss Tg Tagging
DMFCN = N/N/N							D - Duplex SS H - Hasteloy I - Incoloy M - Monel S - 316 SS X - SPECIAL	

We reserve the right to change specifications stated in this leaflet due to our continuing programme of development. All valves have 'T' Bar handle as standard. Anti-Tamper Keys are always supplied separately, for security.

DMFS - 09/09

Colson
Industries Ltd

Website: www.colson.co.uk

e-mail: sales@colson.co.uk



Certificate No LRQ 0960294
ISO 9001 Registered

Park Works, Park Road,
ELLAND. West Yorkshire.
HX5 9HN - England

Tel +44 (0) 845 0943 780
Fax +44 (0) 845 0943 790